

How it Works

MC-200 Audio System

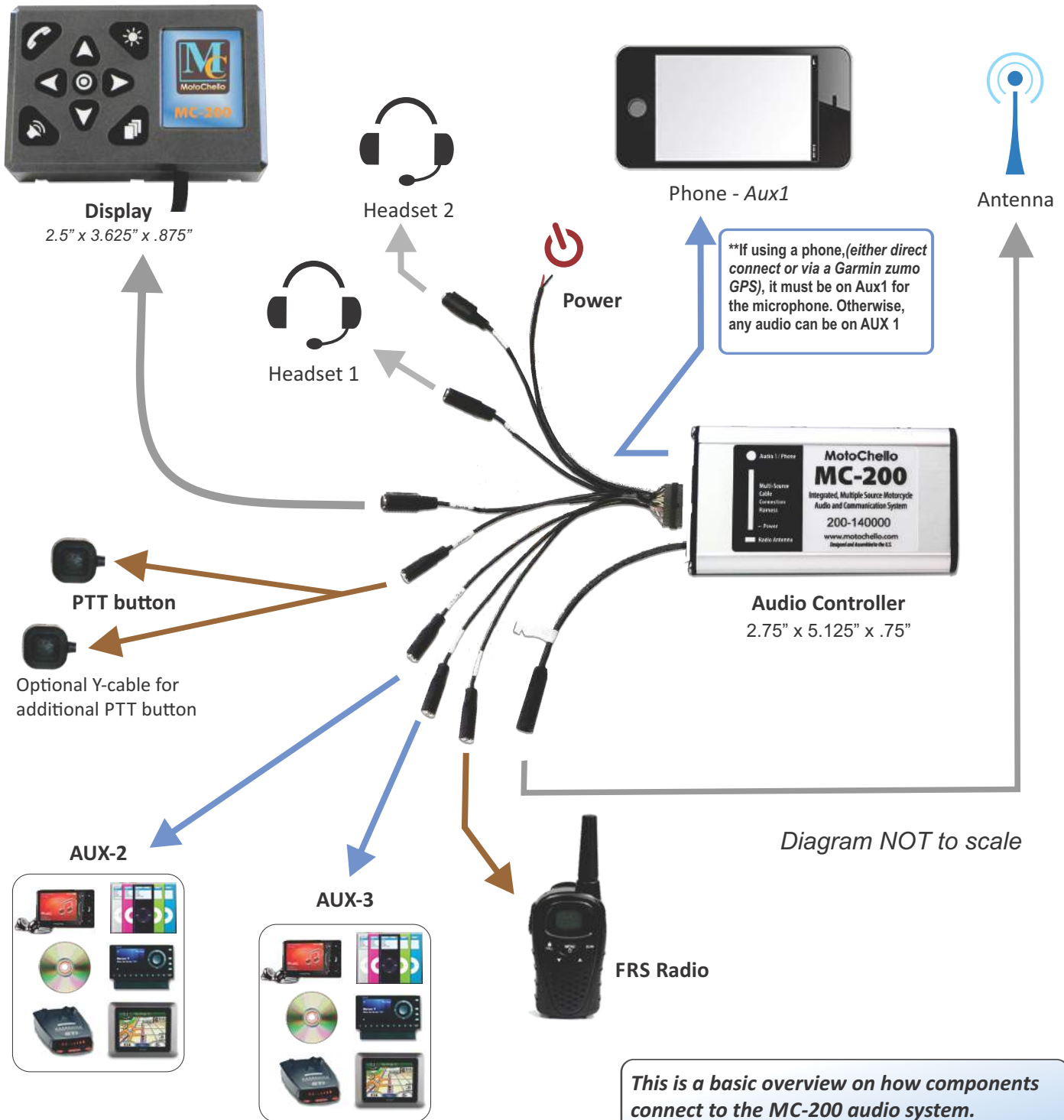

This is a basic overview on how components connect to the MC-200 audio system.

The Display mounts to the handlebars for operational ease and access, but can be removed when you don't plan to talk on the phone or change radio stations while riding.

MotoChello INC

Gardnerville, NV • (775) 782-2203

www.motochello.com

©2014 MotoChello, Inc.