

Helmet Headset Harness Diagram

General Guide for MotoChello Headset Harness Installation

Use the helmet headset harness to connect helmet speakers, microphone and coiled headset connection cable together. The adhesive backing secures the position to the inside of your helmet under the foam liner. Snap connectors keep it simple.

Connect wires as listed

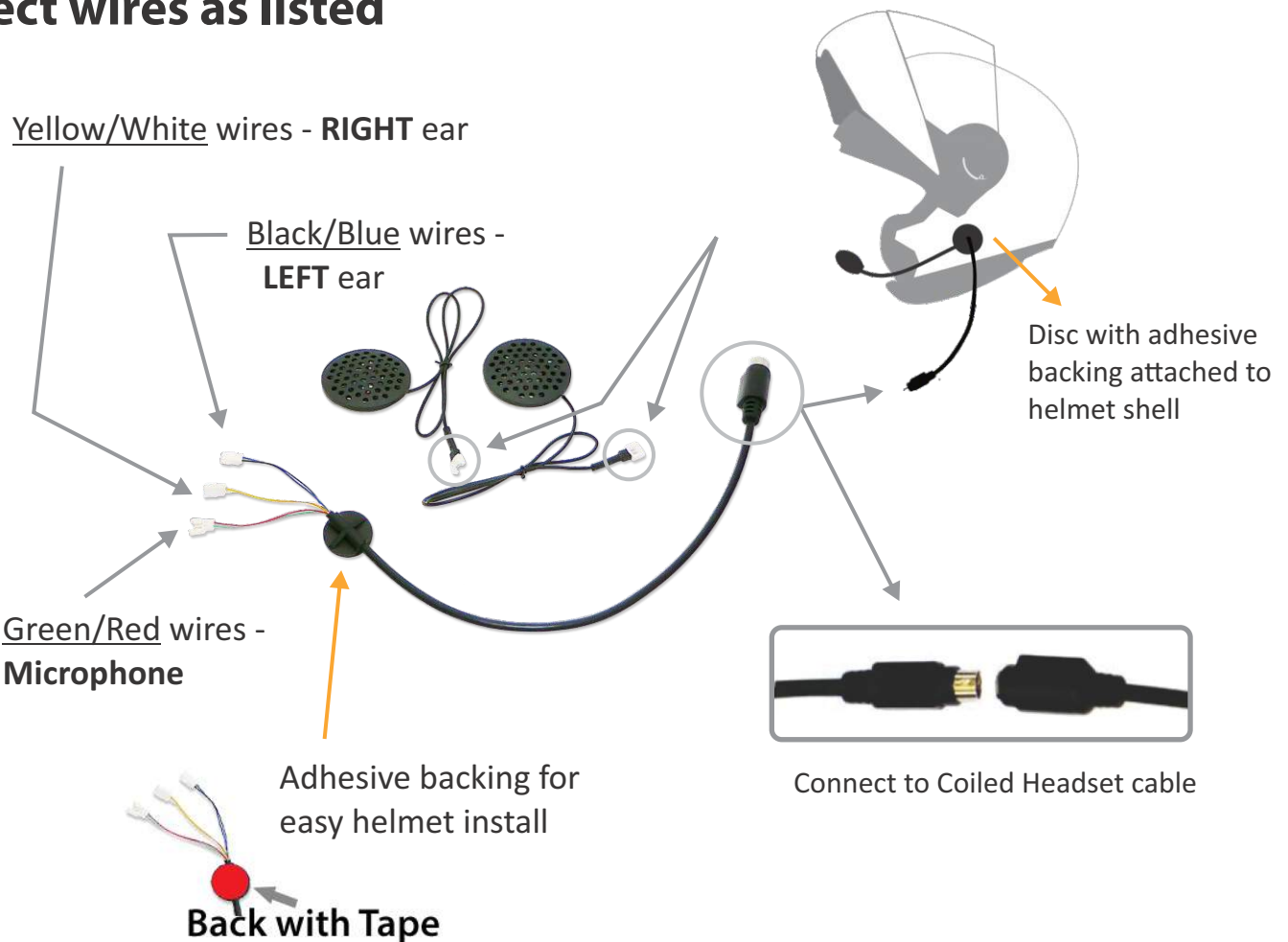

WARNING: The harness connectors, while compact, have a firm hold. Should you need to disconnect them for any reason, it is strongly advised that you use needle nosed or small pliers on each end to pull apart. Otherwise, the connectors and/or wires may become damaged.

Should you need help installing your headset harness, please contact MotoChello support for assistance.

MotoChello • 775 / 782-2203 • support@motochello.com



www.motochello.com